

Prepare



Sable Seek
Seek
Ultracare
Extend-A-Life
PropGard
InterGuard
STARbrush
Omni-Matrix Sectional
Omni-Matrix
OraSeal
DermaDam
DermaDam Synthetic
DermaFrame
Consepsis Scrub



Prepare

Sable™ Seek® and Seek® CARIES INDICATORS



Black Mini Brush tip
#1432 - 500pk - pg 128

- Identifies demineralized dentin
- Provides precise, mess-free delivery
- Available in dark green for working near pulp
- Available in red for easily identifying root canal orifices

Sable Seek caries indicator, containing FD & C dyes, and Seek caries indicator, containing D & C dyes in a glycol base, stain carious dentin.

Uses

Seek and Sable Seek identify demineralized dentin in difficult-to-see places — for example, under the overhanging enamel of Class I, II, or III preparations, or along the DE junction of the preparation. Green Sable Seek prevents over-excavating deep caries, which can lead to pulp exposure. Non-mineral dentin should be removed to improve the bond strength of the entire restoration. Red Seek is easily visible on dark dentin and provides a fast, effective way to locate calcified root canal orifices.



1. Apply Sable Seek with brush tip. Rinse with air/water spray while vacuuming. Identify non-mineral affected dentin caries in difficult-to-see locations.



2. Remove green-black color (carious dentin) with slow speed round bur or excavator. To prevent over-excavating, remove final portions of caries with hand instrument.



3. Reapply Sable Seek. Rinse and verify complete caries removal.



Seek and Find

#233 - Sable Seek Kit

- 4 - 1.2ml syringes
- 20 - Black Mini Brush tips



Shelf Life: 36 months.

#234 - Sable Seek Refill

- 4 - 1.2ml syringes



Shelf Life: 36 months.

#1805 - Sable Seek Econo Refill

- 20 - 1.2ml syringes

#209 - Seek Kit

- 4 - 1.2ml syringes
- 20 - Black Mini Brush tips



Shelf Life: 36 months.

#210 - Seek Refill

- 4 - 1.2ml syringes



Shelf Life: 36 months.

#1804 - Seek Econo Refill

- 20 - 1.2ml syringes



Ultracare®
ORAL ANESTHETIC GEL



Micro Capillary tip
#1802 - 100pk - pg 131



Blue Micro tip
#1436 - 500pk - pg 129

Ultracare is a delightfully flavored 20% benzocaine oral anesthetic gel for rapid, profound topical anesthesia. Deliver it via syringe using the Micro Capillary tip or Blue Micro tip to increase patient comfort during subgingival scaling and root planing.



Ultracare can be delivered directly onto a cotton swab or expressed from a 1.2ml syringe through a Micro Capillary tip or a metal Blue Micro tip. Use these tips during root planing in deep perio pockets or for inducing anesthesia prior to rubber dam placement, etc.

#983 - Ultracare Walterberry Kit

- 20 - 1.2ml syringes
- 20 - 5mm Micro Capillary tips
- 20 - Blue Micro tips

NOT AVAILABLE IN ALL COUNTRIES



Shelf Life: 48 months.

- #301 - Walterberry Bottle
- #302 - Bubble Gum Bottle
- #308 - Crème de Menthe Bottle
- #310 - Piña Colada Bottle
- #312 - Butter Rum Bottle

1 - 30ml bottle

NOT AVAILABLE IN ALL COUNTRIES



Shelf Life: 48 months.

- #359 - Walterberry IndiSpense Syringe
- #357 - Bubble Gum IndiSpense Syringe

1 - 30ml syringe

NOT AVAILABLE IN ALL COUNTRIES



Shelf Life: 48 months.

Extend-A-Life™

DISPOSABLE DIAMOND CLEANING CHIPS



Uses

Extend-A-Life diamond cleaning chips are aluminum oxide stones designed to debride clogged diamond burs and remove acrylic from carbide burs.



All diamond burs clog. This degree of clogging occurred with only two preps.



Same bur 12 preps later.
(Cleaned with Extend-A-Life)



With water spray, cut 1–2 seconds or approximately 1/4" into Extend-A-Life chip. Clean between and/or during each prep as needed.

#115 - Extend-A-Life

50 - Cleaning chips



PropGard®

MOUTH PROP



- Cold disinfection (do not autoclave)

Uses

PropGard's wedge design prevents contamination from tongue and mouth closure and also protects the tongue from the handpiece.



PropGard protects adjacent teeth and tongue.

#4100 - PropGard Kit

10 - PropGards - 5 large yellow and 5 regular purple
20 - Tongue guards - 10 left and 10 right



Soft

#4105 - PropGard Yellow Regular - 5pk Refill

#4103 - PropGard Yellow Large - 5pk Refill

Firm

#4101 - PropGard Purple Regular - 5pk Refill

#4104 - PropGard Purple Large - 5pk Refill



#4102 - Tongue Guard Refill

10 - Tongue Guards - 5 right and 5 left



InterGuard®



InterGuard ensures a faster, safer preparation by protecting the adjacent tooth from iatrogenic damage². Durable stainless steel InterGuard is autoclavable and can be used multiple times. Stable curls at each end leave transition angles clear for full access. InterGuard is great for tunnel preparations and protecting the adjacent tooth during air abrasion.



"InterGuard was developed as a protective shield following the publication of a clinical investigation proving that two-thirds of the approximal surfaces of adjacent teeth showed evidence of iatrogenic preparation damage. In my office I soon found that InterGuard allows you to work both faster and safer, and I am proud to have contributed with a tool which has been called another step in the direction of higher quality dentistry."

DR. OLE OSTERBY, INVENTOR, DENMARK

Turn the curls to face tooth to be prepared. Tie a length of dental floss through the hole, as shown, to prevent patient from swallowing InterGuard.

#3097 - InterGuard Kit

5 - each 4.0mm and 5.5mm



#4016 - InterGuard 4.0mm Refill

#4017 - InterGuard 5.5mm Refill

10 - InterGuards



#4011 - InterGuard 4.0mm Econo Refill

#4012 - InterGuard 5.5mm Econo Refill

50 - InterGuards



STARbrush®

INTERCORONAL BRUSH



Actual Size

- Effectively cleans where nothing else can
- Tight fibers help to prevent messes and apply appropriate pressure
- Ideal for use with Consepsis Scrub

Uses

The STARbrush is excellent for cleaning areas with restricted access. It was designed to clean intra-coronally as well as extra-coronally before bonding fillings, inlays, onlays, and crowns. Use the STARbrush with Consepsis Scrub to remove residual temporary cement without abrading the gingiva. There is no match for STARbrush's access to Class I, II, III, IV, V, and endodontic access preparations. It also cleans around orthodontic brackets or prior to sealant placement. Use STARbrush with a disinfectant or Ultrapro TX prophylaxis paste.

#1091 - STARbrush

30 - STARbrushes



#1092 - STARbrush

50 - STARbrushes



#1093 - STARbrush

100 - STARbrushes



¹ www.realityesthetics.com ² Qvist V, Johannessen L, Bruun M. Progression of approximal caries in relation to iatrogenic preparation damage. J Dent Res 1992;71(7):1370-1373. (Lit. #55)

¹ www.realityesthetics.com

Omni-Matrix™ Sectional

MATRICES AND RETAINER CLAMPS



- Creates restorations with natural anatomy
- Thin, flexible bands easily conform to any surface
- No special matrix pliers required
- One clamp fits all teeth
- Clamps are stackable

Omni-Matrix Sectional bands conform to the natural anatomy of the tooth, while the clamp tines provide multiple contact points. Specialized band contour ensures the edge of the matrix will not catch on the gingival margin during placement. The retainer clamps stack easily, allowing both sides of the tooth to be held in a matrix at the same time. The retainer can be placed with any rubber dam forceps or sectional matrix forceps. The bands are interchangeable with all brands of sectional retainers.

Instructions



1. Place matrices and then wedge.

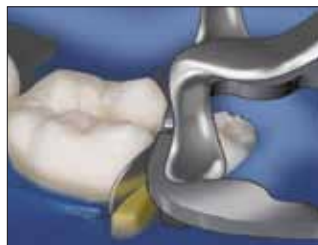

2. Place the retainer clamp.



3. Begin restoration.

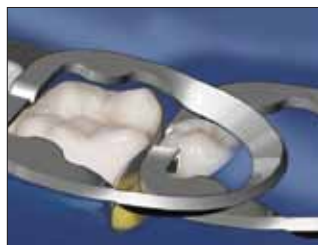

Optional: Stack multiple clamps.

Constant Radius VS. Reverse Curve

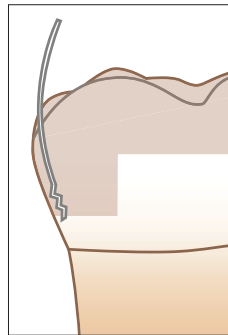

Traditional sectional matrixes often catch on the gingival margin. This prevents you from being able to position it readily, which often deforms the matrix.

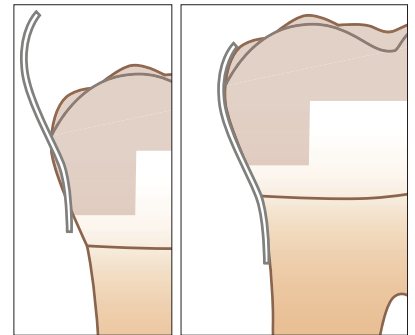

The Omni-Matrix Sectional system was created with the natural structure of the tooth in mind, eliminating the problems experienced with traditional systems.

#318 - Omni-Matrix Sectional Kit

- 4 - Matrix clamps
- 40 - each Regular, Regular Extended, Large, and Large Extended bands



#317 - Omni-Matrix Sectional Clamps

- 4 - Matrix clamps



#304 - Regular Matrix Bands

#305 - Regular Extended Matrix Bands

- 40 - Matrix bands



#309 - Large Matrix Bands

#316 - Large Extended Matrix Bands

- 40 - Matrix bands



Omni-Matrix™

DISPOSABLE RETAINER AND MATRIX



- Aseptic and disposable
- Perfect placement — first time, every time
- Color-coded
- Superior patient comfort
- Adaptive, burnishable band
- No placement instruments required
- No lip, cheek, or glove capture

Omni-Matrix is a quick, easy-to-use, disposable retainer and matrix. Simply adjust the band's circumference by twisting the conical handle. Its patented, articulated head swivels, fitting comfortably into any quadrant of the mouth. Once the restoration is complete, the Omni-Matrix band is easily released, leaving restorative material intact. The stainless steel matrix band is thin, adaptive, and burnishable, and the wingless design allows wedges to be placed with ease.

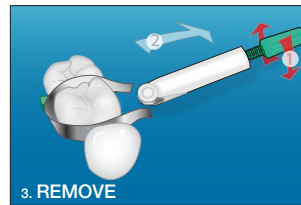
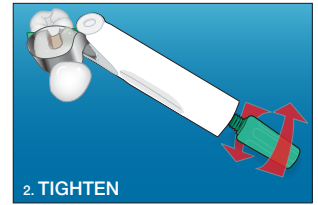
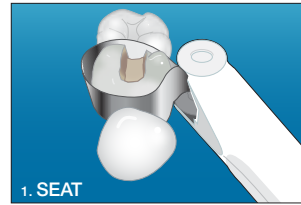

"Fast, easy, convenient, disposable! What else could you ask for?"
- DR. GEORGE FREEDMAN

Winged

#2205 - Omni-Matrix Winged Kit

16 - each 0.001 and Mylar
8 - each 0.0015 and Pedo



- #2201 - Omni-Matrix Winged 0.001 Orange Refill
- #2202 - Omni-Matrix Winged 0.0015 Green Refill
- #2204 - Omni-Matrix Winged Pedo Purple Refill

48 - Omni-Matrix winged



#2203 - Omni-Matrix Winged Mylar Red Refill

48 - Omni-Matrix wingless



Wingless

#1105 - Omni-Matrix Wingless Kit

16 - each 0.001 and Mylar
8 - each 0.0015 and Pedo



- #1101 - Omni-Matrix Wingless 0.001 Orange Refill
- #1102 - Omni-Matrix Wingless 0.0015 Green Refill
- #1104 - Omni-Matrix Wingless Pedo Purple Refill

48 - Omni-Matrix wingless



#1103 - Omni-Matrix Wingless Mylar Red Refill

48 - Omni-Matrix wingless



¹ www.realityesthetics.com

Prepare

OraSeal® CAULKING AND PUTTY



White Mac tip
#1480 - 500pk - pg 133

- Adheres under water and saliva



OraSeal seals leaks in a rubber dam, even when submerged. Apply around border, then criss-cross over hole while expressing OraSeal until seal is complete.

OraSeal caulking and putty material effectively adheres to wet rubber dams, wet gingival and mucosal tissues, wet teeth, metals, etc. — even under water or in saliva!

Uses

Use OraSeal Caulking when an adequate seal is difficult to obtain with compromised teeth or roots; OraSeal may also be used to repair rubber dam leaks. It seals the rubber dam when performing a porcelain repair, protecting gingiva from hydrofluoric acid. Deliver into undercuts and below implant bars, precision attachments, etc. to prevent cold cure acrylic or impression material from locking into empty spaces. Fill in gingival embrasures of splints and bridges to facilitate easy cleanup of permanent cement. OraSeal Putty can perform the same functions, but it has a stiffer consistency, which some doctors prefer.

Procedure



Apply OraSeal Caulking with the Black Mini or White Mac delivery tips to prevent leakage of rubber dam during treatment.² Shape with wet gloved finger, wet cotton swab, or instrument. The procedure can then be performed in a clean, dry field.

¹ www.realityesthetics.com ² Cohen S, Burns RC. Pathways of the Pulp Seventh Edition. Mosby, 1998 pp 123-124

Uses for OraSeal:



Ensures rubber dam seal when using strong peroxide for vital bleaching, or when porcelain etching with hydrofluoric acid.



Putty blocks out undercuts below and around prosthetic implant clip. Flexing component of clip is covered with putty to accommodate clip flexure during insertion and removal.



Ensures moisture control when bonding lower orthodontic brackets. Seal with Caulking or Putty to prevent saliva from seeping through embrasures and contaminating the area.



Blocks out large interproximal spaces for easy and distortion-free removal of impression.



Putty can be used under fixed partial or implant bar prior to making an impression.



Putty can be used as a block-out medium prior to anchoring attachments, clips etc., with cold cure acrylic.

#352 - OraSeal Kit

- 2 - ea 1.2ml OraSeal Caulking and OraSeal Putty syringes
- 4 - Black Mini tips
- 20 - White Mac tips



Shelf Life: 24 months.



- #351 - OraSeal Caulk Refill
- #353 - OraSeal Putty Refill
- #354 - OraSeal Caulk Econo Refill
- #355 - OraSeal Putty Econo Refill

4 - 1.2ml syringes

20 - 1.2ml syringes

Shelf Life: 24 months.



DermaDam®

RUBBER DAM



- Low dermatitis potential
- Strong and tear-resistant
- Powder-free to reduce allergic reactions

Uses

DermaDam is made from pure latex rubber and is powder-free, which reduces the possibility of latex reactions. Quality processing ensures a low content of surface proteins.

#321 - DermaDam Kit

36 - 6" x 6" (15cmX15cm) DermaDam Medium
5 - DermaFrames

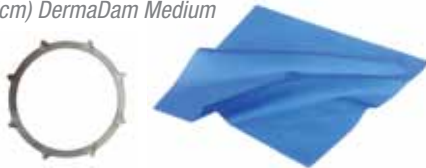

#311 - DermaDam Medium - 0.20mm Refill

36 - 6" x 6" (15cmX15cm) DermaDam Medium



#314 - DermaDam Heavy - 0.25mm Refill

36 - 6" x 6" (15cmX15cm) DermaDam Heavy



DermaDam® Synthetic

RUBBER DAM

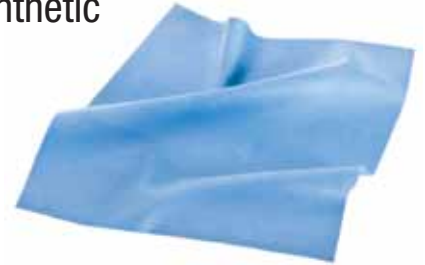

DermaDam Synthetic contains zero sensitizing proteins and is powder-free to eliminate allergic reactions to powder and contamination to preparations. This is not a latex rubber.

#299 - DermaDam Synthetic - 0.20mm Refill

20 - 6" x 6" (15cmX15cm) DermaDam Medium

Zero sensitizing proteins



DermaFrame™

RUBBER DAM FRAME

- Pliable metal secures dam while improving patient comfort
- Flexibility facilitates radiographs without dam or frame removal
- Use with DermaDam for optimal results

#3121 - DermaFrame

5 - DermaFrames



¹ www.realityesthetics.com

Consepsis® Scrub

CHLORHEXIDINE ANTIBACTERIAL SLURRY



White Mac tip
#1480 - 500pk - pg 133

- Reduces post-op sensitivity
- Does not compromise bond strength
- Comes in a non-splatter formula
- Scrubs, cleans, and disinfects in one operation

Consepsis Scrub is a lightly flavored, 2.0% chlorhexidine gluconate (relative to liquid component) disinfecting scrub. Instead of powdered pumice, which may contain several trace impurities from volcanic ash, Consepsis Scrub uses inert, finely ground Pyrex®* glass as an abrasive scrub. (Never use prophylactic paste for prep cleaning, as it contains several potentially contaminating ingredients.)

Uses

Use Consepsis Scrub for removing residual temporary cement prior to permanent cementation and/or cleaning debris while disinfecting. Scouring with a quality disinfectant prior to restoring minimizes the potential for post-op sensitivity associated with an influx of microorganisms into dentinal tubules.



Before

After

Evidence demonstrates that you can further reduce post-op sensitivity by sealing dentin before cementation. Use PermaFlo DC as your luting resin.

See page 69 for Consepsis chlorhexidine antibacterial solution.

Use Consepsis Scrub with a rubber cup or the STARbrush (shown here) to remove residual cement.



#730 - Consepsis Scrub Kit

- 4 - 1.2ml syringes
- 2 - STARbrushes
- 20 - White Mac tips

NOT AVAILABLE IN ALL COUNTRIES



Shelf Life: 36 months.

#546 - Consepsis Scrub IndiSpense Kit

- 1 - 30ml IndiSpense syringe
- 2 - STARbrushes
- 20 - White Mac tips
- 20 - 1.2ml empty syringes

NOT AVAILABLE IN ALL COUNTRIES



Shelf Life: 36 months.

#732 - Consepsis Scrub Refill

- 4 - 1.2ml syringes

NOT AVAILABLE IN ALL COUNTRIES



Shelf Life: 36 months.

#689 - Consepsis Scrub IndiSpense Syringe

- 1 - 30ml syringe

NOT AVAILABLE IN ALL COUNTRIES



Shelf Life: 36 months.

1 www.realityesthetics.com *This tradename belongs to a company other than Ultradent.

Clinical Pointer

PROBLEM: STAIN UNDER HYDROPHOBIC PROVISIONAL CEMENT

SOLUTION: Use sealing provisional hydrophilic cements (i.e., UltraTemp)

CHEMISTRIES (THE "WHYS"):

1. Non-sealing cements allow saliva and bacteria to move between the temporary and preparation.
2. Coagulum within cut tissues is a source of iron, which reacts with the hydrogen sulfide gas (rotten egg gas, H₂S) produced by anaerobic bacteria in this septic environment. The reaction yields ferric sulfide, the harmless yet annoying dark surface stain shown on the right. This stain can occur to a lesser degree from the natural iron in blood. Additionally, non-sealing provisionals are problematic as saliva and/or bacteria removes the smear layer within one week, opening tubules to bacteria.

HOW TO PREVENT:

Either use an antimicrobial temporary cement (like ZOE), which leaks, but at least prevents bacterial growth, hence no H₂S and no formation of ferric sulfide...

OR BETTER YET:

Use a quality sealing provisional cement like Ultradent's non-eugenol, hydrophilic, polycarboxylate, paste-to-paste UltraTemp cement.

Similar staining can occur even under definitive direct or indirect restorations if contamination is on the preparation prior to bonding. Scour and/or etch as needed prior to DBA application. For scouring, we recommend ConsepSis Scrub with a STARbrush.



Two weeks earlier upon preparation, ViscoStat with Dento-Infusor was used to arrest bleeding. Provisional crowns were cemented with a popular NON-sealing, hydrophobic, resin-based temporary cement. NOTE dark color migrating from gingival margin inward.



Here on another patient, provisionals have been removed. Characteristic dark stain is observed on preparations. This can be removed by ultrasonic scaling and scouring with ConsepSis Scrub. It's preferable to prevent it by using hydrophilic provisional cements such as UltraTemp.

The screenshot shows the Ultradent eNewsletter interface. At the top, it says 'ULTRADENT - NEWSLETTER'. Below that is a section titled 'Ultradent Elite Program Qualification' with a deadline of 12/31/12. It lists various dental offices and their contact information. There is also a 'Celebrity Shopping Cart' section featuring a photo of Dr. Reese Burgin. At the bottom, there are social media icons for Twitter and Facebook, and a footer with the website address www.ultradent.com.

Ultradent's eNewsletter

Subscribe to Ultradent's free eNewsletter to receive exclusive promotions, clinical tips, new product information, and continuing education updates.

Visit <http://www.ultradent.com/newsletters/> to sign up today!





EARN FREE CE CREDITS AT YOUR CONVENIENCE

Now you can receive CE credit for listening to Ultradent's free podcast. Simply listen to a "course" of episodes totaling an hour and take the online test to receive your certificate for one CE credit hour.

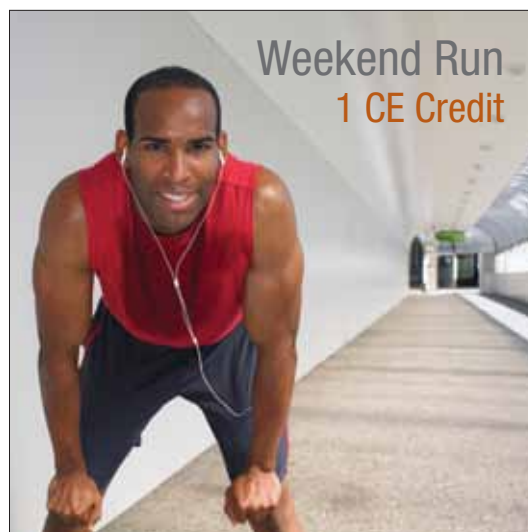

JUST A FEW OF OUR MANY COURSES...



FUNDAMENTALS OF BLEACHING:
Dr. Dan Fischer and
Dr. Van Haywood
Audio Course



MANAGING PATIENTS
AND PROCEDURES
FOR A SUCCESSFUL
PRACTICE:
Dr. Stace Lind
Audio Course



THE "WHY'S" BEHIND
SUCCESSFUL BONDING:
Dr. John Flucke
Video Course

And we're adding more all the time!

Visit learningcenter.ultradent.com today.

1.800.268.9010